

Project:

Swierczyny\_gm. Bartniczka

Printed/Page

2015-07-29 10:13 / 1

Licensed user:

WindProject

ul. Sokola 13/6

PL-82 500 Kwidzyn

+48 609540877

mgr Alina Cieslak / a.cieslak@windproject.pl

Calculated:

2015-07-29 08:59/2.9.285

## DECIBEL - Main Result

Calculation: EW planowane\_GF=0\_pora dnia

Noise calculation model:

ISO 9613-2 General

Wind speed:

10,0 m/s

Ground attenuation:

General, Ground factor: 0,0

Meteorological coefficient, C0:

0,0 dB

Type of demand in calculation:

1: WTG noise is compared to demand (DK, DE, SE, NL etc.)

Noise values in calculation:

All noise values are mean values (Lwa) (Normal)

Pure tones:

Pure and Impulse tone penalty are added to WTG source noise

Height above ground level, when no value in NSA object:

4,0 m Allow override of model height with height from NSA object

Deviation from "official" noise demands. Negative is more restrictive, positive is less restrictive.:

0,0 dB(A)

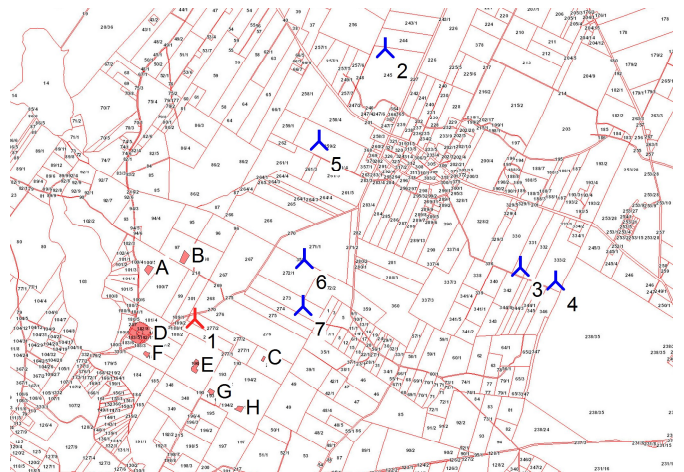

Scale 1:50 000

New WTG

Noise sensitive area

## WTGs

Polish GK 1992/19-ETRS89				WTG type		Type-generator		Power, rated		Rotor diameter		Hub height		Noise data		Wind speed		Status		Lwa_ref		Pure tones	
East	North	Z	Row data/Description	Valid	Manufact.			[kW]	[m]	[m]	[m]	Creator	Name	[m/s]		[dB(A)]							
		[m]																					
1	531 077	595 124	142,9	1 MW	No	elektrownia wiatrowa 1,0 MW	-1 000	1 000	60,0	80,0	USER	Level 0 - measured - 0 -07-2006	10,0	User value	102,0	0 dB	h						
2	532 332	596 911	136,0	Swierczyny 245	No	elektrownia wiatrowa 1000 kW	-1 000/250	1 000	60,0	80,0	USER	8m/s WICO/Man 18-09-99	10,0	User value	102,0	0 dB	h						
3	533 224	595 469	143,3	Swierczyny 331; 336	No	elektrownia wiatrowa 2,0	-2 000	2 000	71,0	85,0	USER	Level 0 - man.spec. - OM I / Rev 1.1 - 04/2012	10,0	User value	103,0	0 dB	h						
4	533 457	595 372	135,5	Swierczyny 333/2	No	elektrownia wiatrowa 2,0	-2 000	2 000	71,0	85,0	USER	Level 0 - man.spec. - OM I / Rev 1.1 - 04/2012	10,0	User value	103,0	0 dB	h						
5	531 895	596 303	139,4	Brodnica-Podgorz-EW1	Yes	VESTAS	V90-2 000	2 000	90,0	125,0	EMD	Level 0 - calculated - Mode 0 - 07-2009	10,0	User value	104,0	0 dB	h						
6	531 799	595 519	152,0	Brodnica-Podgorz-EW3	Yes	VESTAS	V90-2 000	2 000	90,0	125,0	EMD	Level 0 - calculated - Mode 0 - 07-2009	10,0	User value	104,0	0 dB	h						
7	531 791	595 207	142,7	Brodnica-Podgorz-EW4	Yes	VESTAS	V90-2 000	2 000	90,0	125,0	EMD	Level 0 - calculated - Mode 0 - 07-2009	10,0	User value	104,0	0 dB	h						

h) Generic octave distribution used

## Calculation Results

### Sound Level

No.	Name	East	North	Z	Imission height	Noise	From WTGs	Distance to noise demand	Demands fulfilled ?
				[m]	[m]	[dB(A)]	[dB(A)]	[m]	Noise
A	A	530 769	595 418	142,0	4,0	55,0	41,6	392	Yes
B	B	531 004	595 490	144,0	4,0	55,0	43,3	338	Yes
C	C	531 529	594 879	142,3	4,0	55,0	44,4	473	Yes
D	D	530 712	595 032	136,5	4,0	55,0	42,1	340	Yes
E	E	531 082	594 861	141,6	4,0	55,0	45,2	231	Yes
F	F	530 779	594 898	135,9	4,0	55,0	42,2	339	Yes
G	G	531 174	594 662	140,3	4,0	55,0	41,3	444	Yes
H	H	531 359	594 547	140,4	4,0	55,0	40,0	612	Yes

### Distances (m)

NSA	1	2	3	4	5	6	7
A	425	2103	2422	2657	1375	998	1022
B	373	1879	2185	2423	1142	759	823
C	515	2186	1785	1980	1471	695	418
D	376	2482	2551	2767	1737	1192	1093
E	263	2402	2214	2416	1656	969	779
F	374	2544	2512	2721	1795	1195	1059
G	473	2530	2180	2366	1794	1057	811
H	643	2549	2050	2222	1831	1058	775